

Landscape Spatial Study

Central Park

Estimated Site Area: 250,000m²
 Park Category: City Park

The Central Park is the largest park within the university. It is located within the core of the KSU. The Central Park will provide a lot of amenities like Amphitheatre and Sports Zone, Outdoor study area, Gathering spaces etc. according to the adjacent vicinity. The park is categorized as a City Park because of its size and character, this park will not only cater KSU but also the outside KSU and the surrounding area.

- 1** Arrival Plaza
- 2** Central Plaza
- 3** Central fountain
- 4** Terrace Lawn
- 5** Amphitheatre / Courtyard steps
- 6** Fitness track
- 7** Kiosk & Café
- 8** Retail hubs
- 9** Community Lawn
- 10** Skate Park / Pump Track
- 11** Sports Courts
- 12** Fitness Area
- 13** Mosque
- 14** Outdoor Study Area
- 15** Nature groove
- 16** Gathering / Barbeque & Picnic Area
- 17** Play Area (for different age group)

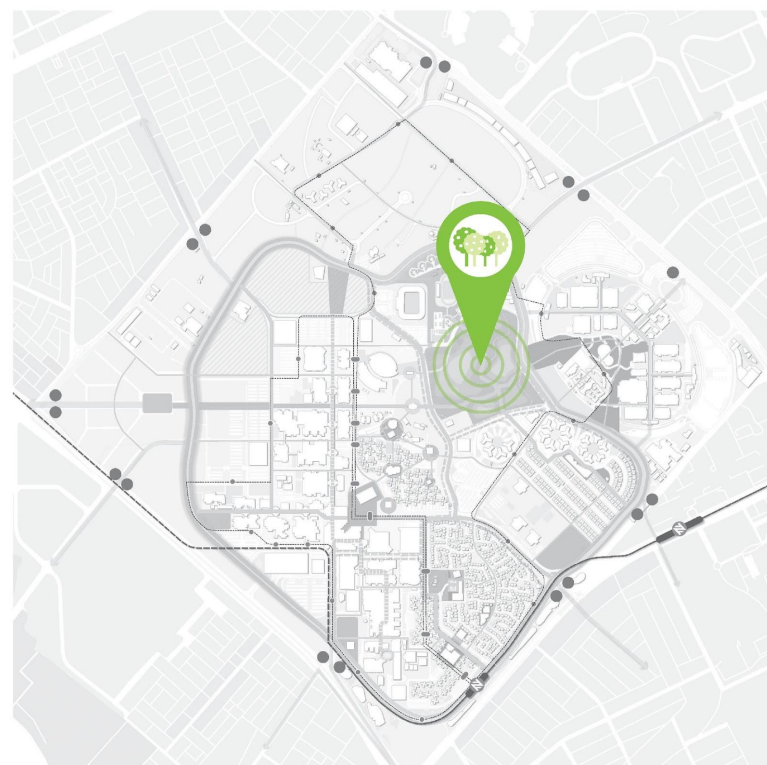

Landscape Spatial Study

Park Programming - City Park

- **Central Park** – This will be the largest park in the KSU campus. The park will be classified as a City Park

Adapting the Programme by Size of the Park

2.2.11.1

		NATURAL CITY PARKS	URBAN CITY PARKS			
		No size limit	50,000-100,000m ²	100,000-300,000m ²	300,000-1,000,000m ²	>1,000,000m ²
MAIN ENTRANCE / ARRIVAL SPACE	Visual & Physical Connectivity/Context	✓	✓	✓	✓	✓
	Entry plaza/Arrival space	✓	✓	✓	✓	✓
	Secondary entrances	✓	✓	✓	✓	✓
	Dedicated parking (off street)	✓	✓	✓	✓	✓
	Bicycle parking	✓	✓	✓	✓	✓
		✓	✓	✓	✓	✓
CIRCULATION	Primary path network	✓	✓	✓	✓	✓
	Secondary/Tertiary path network	✓	✓	✓	✓	✓
	Emergency vehicle circulation	✓	✓	✓	✓	✓
	Shared bicycle track/ Footpath	✓	✓	✓	✓	✓
	Jogging track	○	○	✓	✓	✓
AMENITIES	Toilet block	✓	✓	✓	✓	✓
	Ablution with prayer room	✓	✓	✓	✓	✓
	Small kiosk (8-15 m ²)	✓	✓	✓	✓	✓
	Large kiosk (15-50 m ²)	○	○	○	○	○
	Public art	○	○	✓	✓	✓
GENERAL ACTIVITIES ACTIVE (part 1)	Play <2-5 yrs old	○	✓	✓	✓	✓
	Play 5-12 yrs old	○	✓	✓	✓	✓
	Play +12 yrs old	○	✓	✓	✓	✓
	Multi-use games area (MUGA) ¹	✗	○	✓	✓	✓
	Half basketball court	✗	○	✓	✓	✓
	Soccer pitch 7x7	✗	○	✓	✓	✓
	Cricket net	✗	○	○	○	○
	Outdoor gym/Fitness trail/Station	○	○	○	✓	✓
GENERAL ACTIVITIES ACTIVE (part 2)	Games area ²	○	✓	✓	✓	✓
	Skate park	✗	○	○	○	○
	Parkour play	✗	○	○	○	○
	Basketball court	✗	○	✓	✓	✓
		✗	○	✓	✓	✓
GENERAL ACTIVITIES PASSIVE	Picnic	✓	✓	✓	✓	✓
	BBQ area singles	✓	✓	✓	✓	✓
	BBQ area grouped	✓	✓	✓	✓	✓
	Water feature/ Water play	○	○	✓	✓	✓
	Clustered seating	✓	✓	✓	✓	✓
	Themed garden ³	○	✓	✓	✓	✓
	Lawn area	✗	✓	✓	✓	✓
	Women/child area	○	✓	✓	✓	✓
	Community garden/ Food garden	✗	✗	✗	✗	✗
	Nursery	○	✓	✓	✓	✓
Central plaza / Event space	✓	✓	✓	✓	✓	
Secondary plaza	✓	✓	✓	✓	✓	
ECO ACTIVITY	Natural habitat area	✓	○	○	○	○
	Maintenance storage area	✓	✓	✓	✓	✓
MAINTENANCE	Maintenance compound	✓	✓	✓	✓	✓
	Maintenance pathway	✓	✓	✓	✓	✓

Table 3 - City Park Programme - Adapting programme by size of the park - Typical elements (part 2 of 2)

- ✓ Should be considered - Appropriate for context
- Could be included - Subject to validation of the catchment and size of park
- ✗ Not required based on park size



¹ MUGA to include multiple ball sports.
² Games area could include table tennis, board games.
³ Themed play could include secret garden, art garden, kinetic garden, sound garden.

Landscape Spatial Study

Central Park

PARK ZONING DIAGRAM

The 3 major zones for the Central Park will be integrated with the adjacent surrounding. The Sports Zone which will be the extended area of the Sports City, The Amphitheatre & Multi-purpose Area for adjacent KSU Campus and the Social Hub which is adjacent to the faculty housing.

-  Sports Zone
-  Amphitheatre & Open Multi-purpose Lawn
-  Social Hub

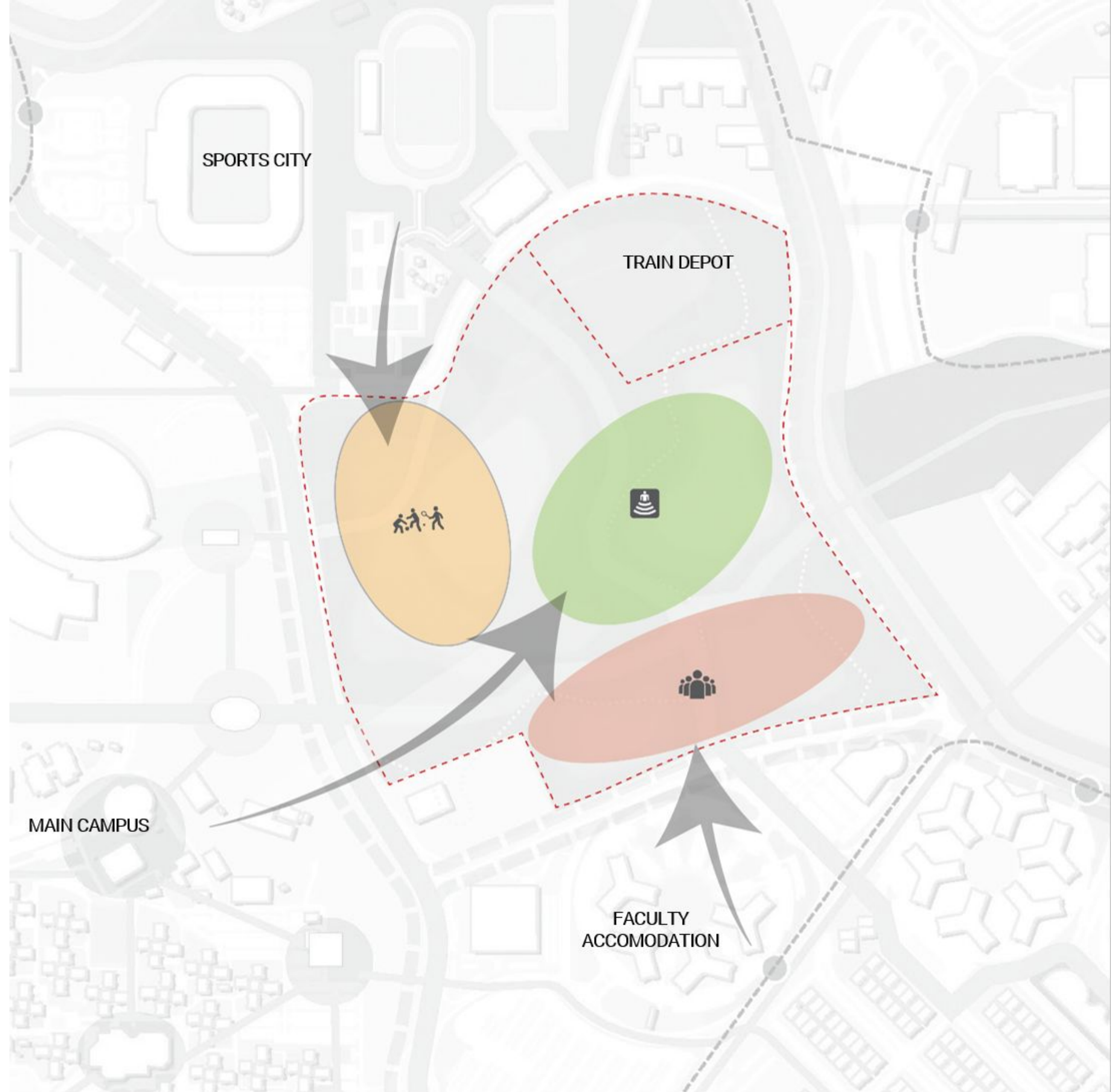
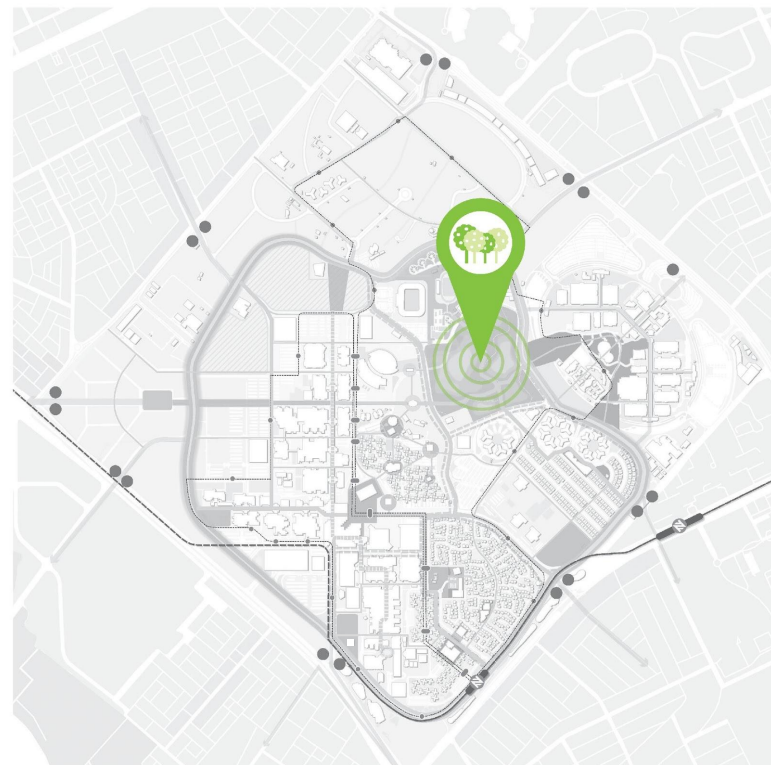









Landscape Spatial Study

Central Park

CIRCULATION DIAGRAM

The layout shows the flow movement that directs the users to the designated space. A Shaded pedestrian pathways to ease the thermal comfort.

-  Green Loop Access
-  Green Way Road
-  Pedestrian Crossing Access
-  Park Main Entrances
-  Secondary Entrances
-  Primary Flow Movement (Pedestrian & Cycle)
-  Secondary Flow Movement (Pedestrian)
-  Cycle Connection Route

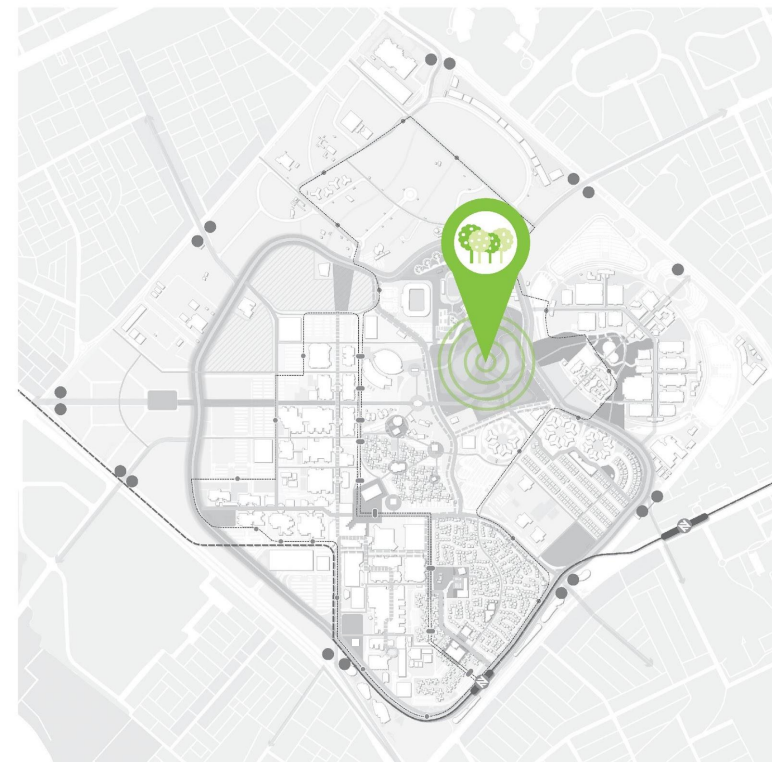

Landscape Spatial Study

Central Park

SPATIAL PROGRAMMING

The spaces of the Central Park shall integrate with the surrounding. The A sports area being the extension of the Sports City, An amphitheatre – for multi-purpose activities shall be located at the centre of the park, an Outdoor Work Space - for the adjacent main campus, a Play Area and Gathering Zone for the adjacent faculty housing.

-  Arrival Zone
-  Activity Hub
-  Sports Zone
-  Amphitheatre & Multi-purpose Lawn
-  Gathering & Picnic Zone
-  Outdoor Work Space
-  Amenities Zone
-  Play Area
-  Nature & Tree Groove
-  Kiosk & Spill-out Cafe

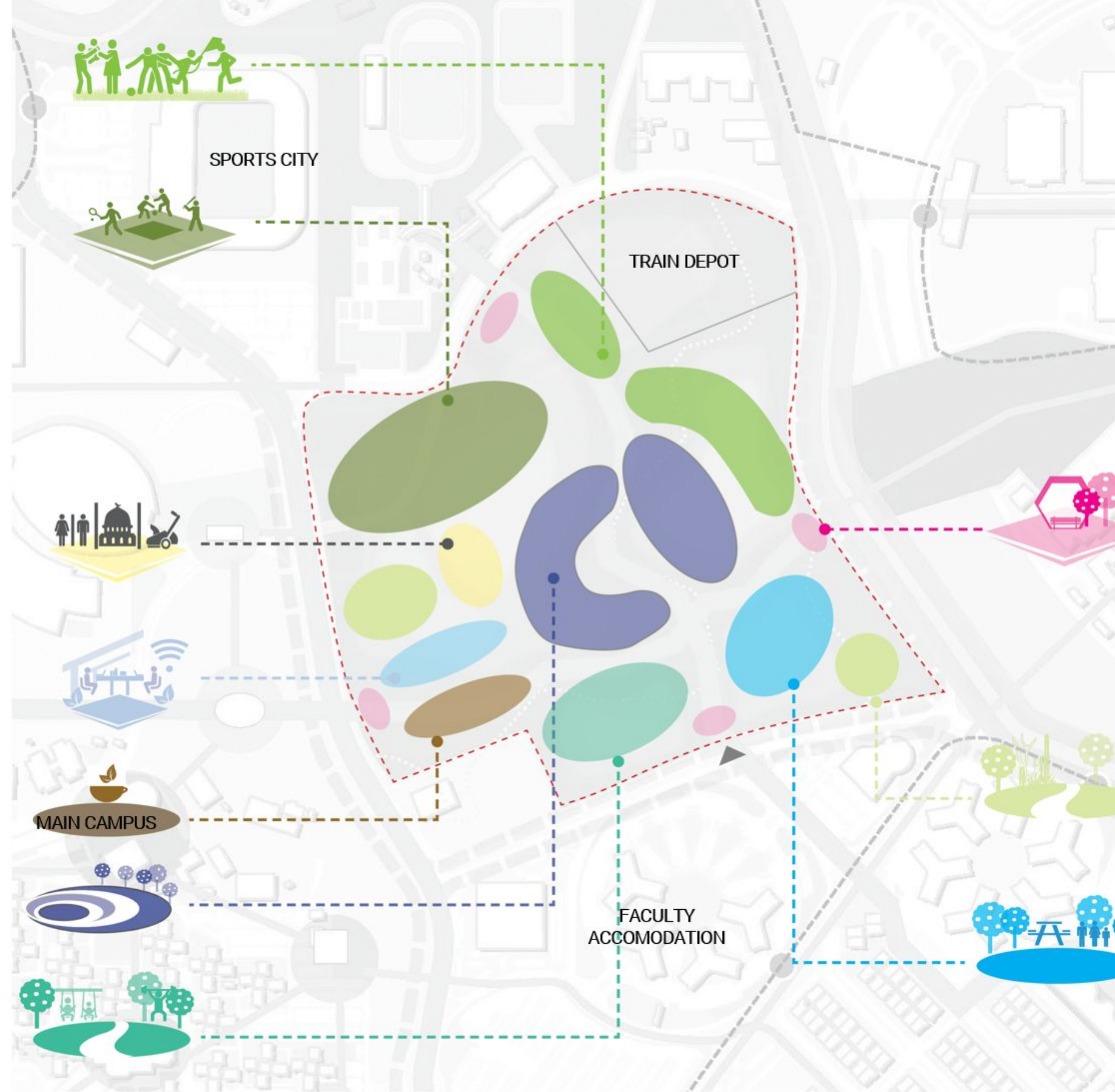
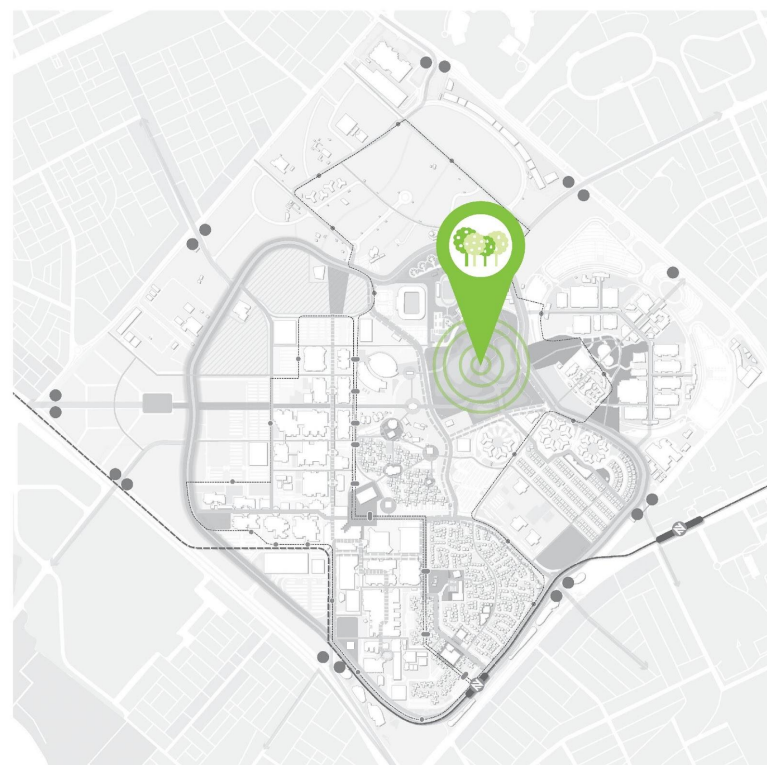

Landscape Spatial Study

Central Park

- 1 **Pathway shade structure** – Canopy over pedestrian pathways. Patterning could be made similarly to the overarching design the central park envisions (ex. Mashrabiya patterning).
- 2 **Community lawn** – Multi-function lawn for general use – picnic, play & community events.
- 3 **Retail hubs** – Array of food stalls & retail kiosks. Would have external seating space.
- 4 **Fitness track** – Segregated & defined pathway for cycling and jogging, which promotes health and wellness at the campus. Would have mobility hubs for cycle racks & seating spots.
- 5 **Courtyard steps** – Steps leading onto the focal gathering space of the park, which is the central fountain.
- 6 **Central fountain** – Focal point and primary social gathering space of the park. The fountain should be activated further by surrounding the space with retail, F&B stalls and entertainment amenities.

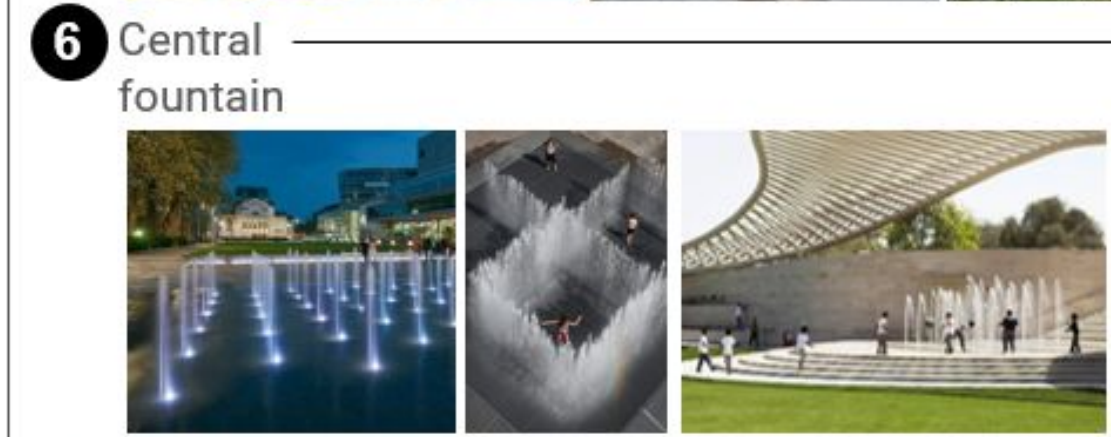
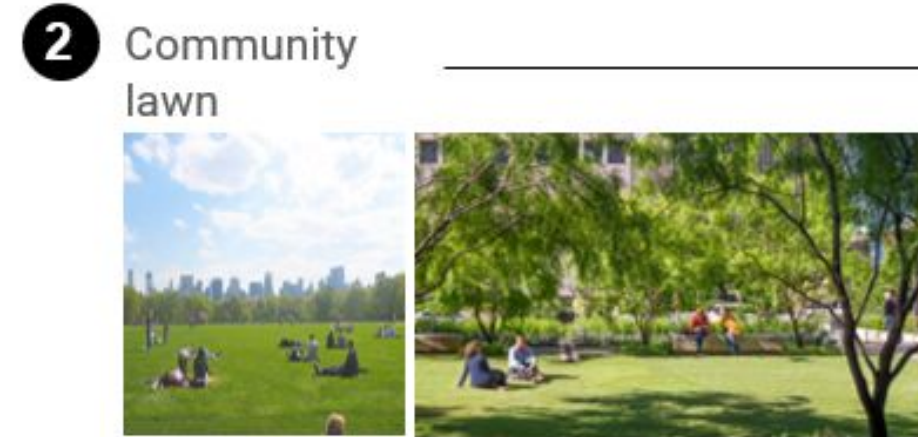

Masterplan Development

Priority Development

Priority development zones are identified along the campus' gateways and its new park.

Total priority development zones (RVC included):
542,532 m²

Total priority open space:
373,733 m²

Heritage walk:
Development: 151,326 m²
Open space: 29,841 m²

Medical City Expansion*:
Development: 59,696 m²
Open space: 26,127 m²

Central Residential Expansion:
Development: 144,672 m²
Open space: n/a

Central Park:
Development: n/a
Open space: 293,891 m²

Innovation Park:
Development: 39,840 m²
Open space: 24,874 m²

Approved RVC projects:
Development: 146,998 m²
Open space: n/a

*Medical City development subject to future study

